

Detail 75-200L Tree Planting on Grade
1:10

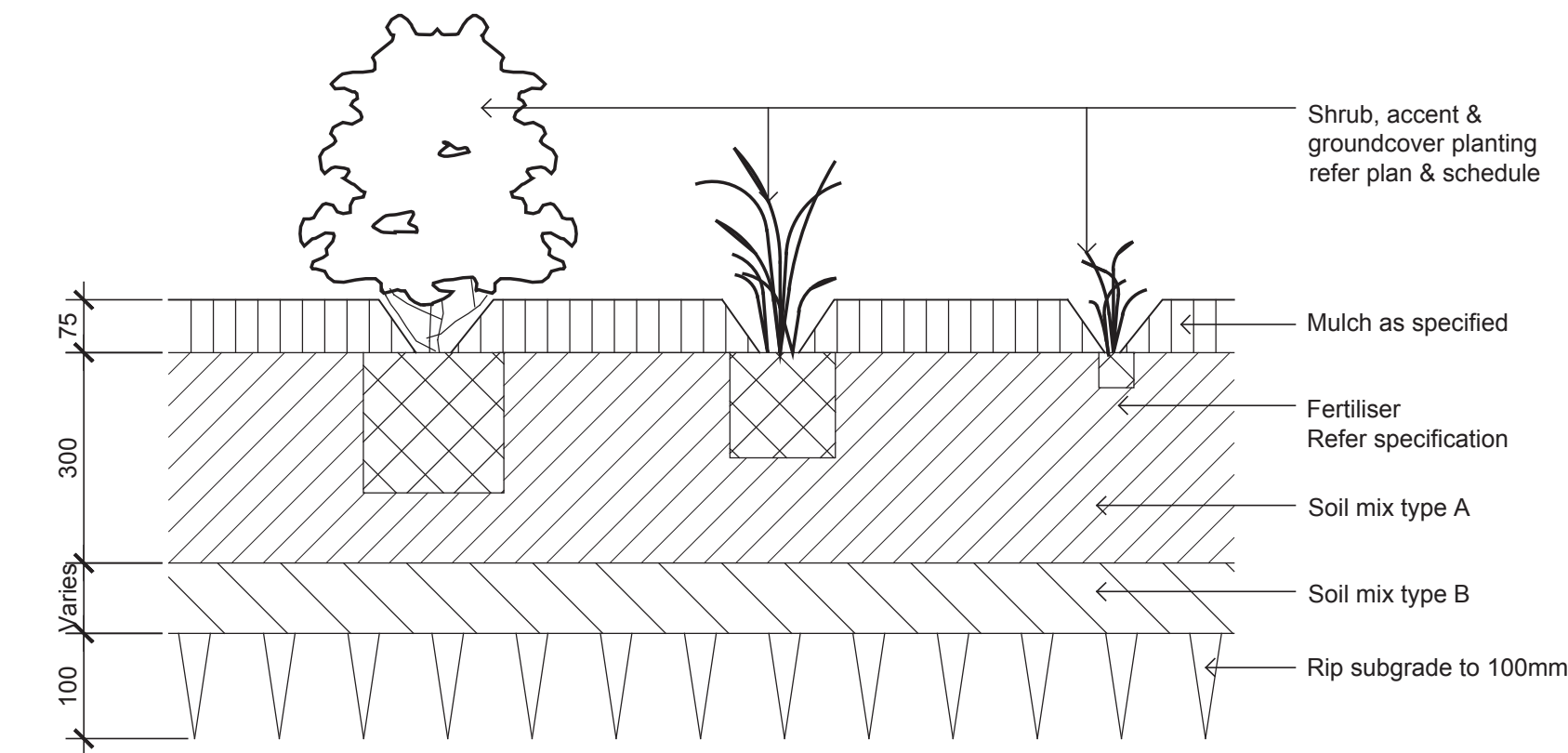

Shrub, Accent and Groundcover Planting on Grade
1:10

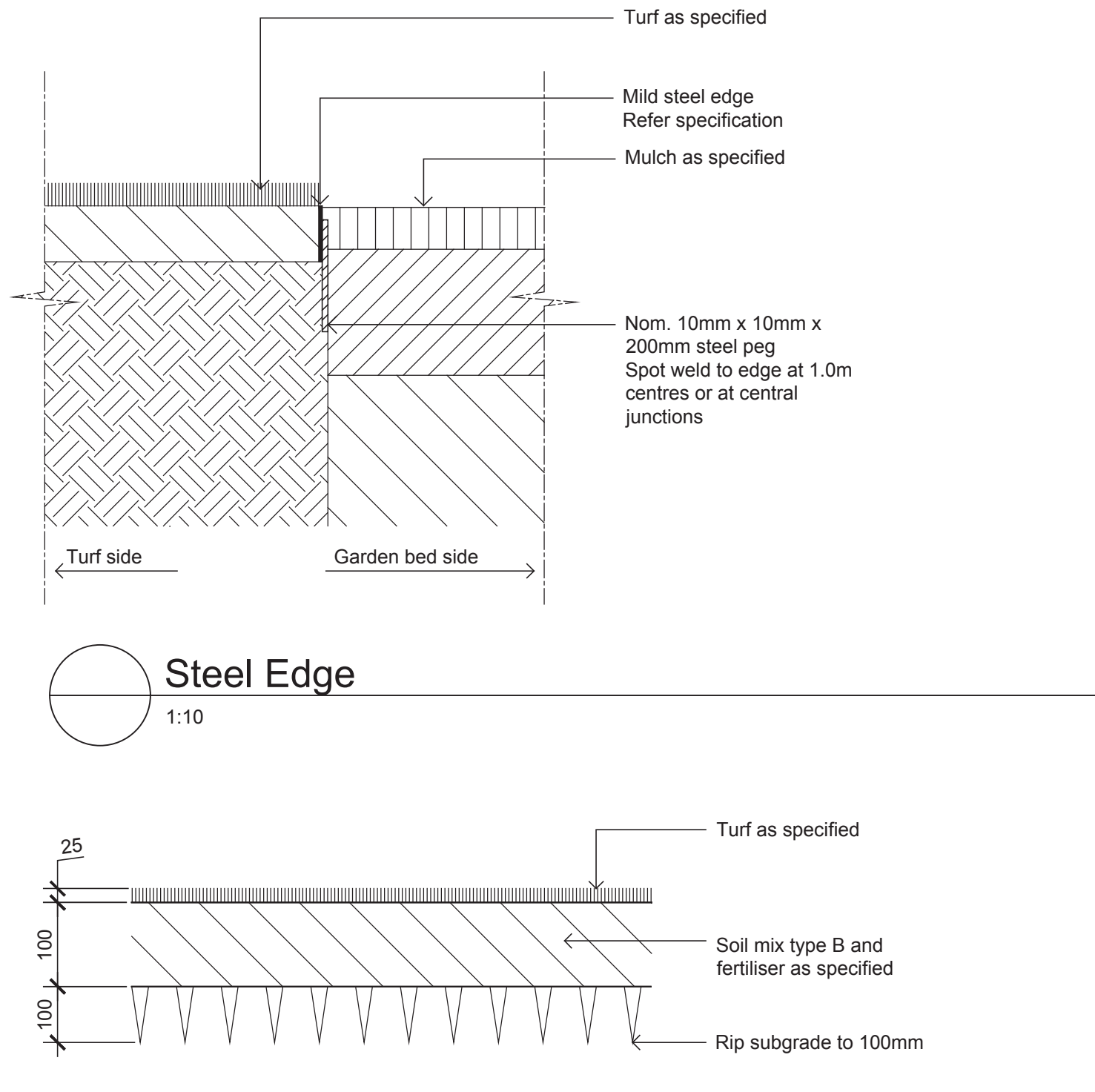

Turf on Grade
1:10

Proposed Plant Schedule

Symbol	Botanic Name	Common Name	Height x Width	Spacing	Pot Size
Trees					
Building 1					
	<i>Magnolia grandiflora</i> 'Exmouth'	Bull Bay Magnolia	12 x 8	As Shown	400L
Building 2					
	<i>Lagerstroemia indica</i> x <i>fauriei</i> 'Natchez'	Crepe Myrtle	6 x 4	As Shown	400L
Building 3					
	<i>Pyrus calleryana</i> 'Chanticleer'	Chanticleer Pear	10 x 5	As Shown	400L
Building 4					
	<i>Gleditsia triacanthos</i> var. <i>inermis</i> 'Sunburst'	Golden Honey Locust	15 x 7	As Shown	400L
Building 5					
	<i>Pistacia chinensis</i>	Chinese Pistachio	6 x 6	As Shown	400L
Building 6					
	<i>Sapium sebiferum</i>	Chinese Tallowood	8 x 8	As Shown	400L
Ca <i>Cupaniopsis anacardioides</i>					
		Tuckeroo	7 x 5		
Cm <i>Corymbia maculata</i>					
		Spotted Gum	30 x 8		
Er <i>Elaeocarpus reticulatus</i>					
		Blueberry Ash	12 x 5		
ML <i>Magnolia grandiflora</i> 'Little Gem'					
		Dwarf Magnolia	5 x 3		
Ms <i>Melaleuca styphelioides</i>					
		Prickly Leaved Paperbark	10 x 3		
Fg <i>Fraxinus griffithii</i>					
		Evergreen Ash	8 x 3		
GS <i>Gleditsia triacanthos</i> 'Sunburst'					
		Honey Locust	8 x 8		
LI <i>Lagerstroemia indica</i> x <i>L.fauriei</i> 'Natchez'					
		Crepe Myrtle (White)	8 x 8		
Lt <i>Liriodendron tulipifera</i>					
		Tulip Tree	13 x 8		
Ns <i>Nyssa sylvatica</i>					
		Black Tupelo	11 x 6		
PcC <i>Pyrus calleryana</i> 'Capital'					
		Capital Pear	11 x 3		
Pu <i>Pyrus ussuriensis</i>					
		Manchurian Pear	9 x 7		
Shrubs / Accents					
De <i>Doryanthes excelsa</i>					
		Gynea Lily	2 x 2	As Shown	45L
NB <i>Nandia domestica</i> 'Blush'					
		Blush Nandina	0.7 x 0.7	As Shown	300mm
Hp <i>Helichrysum petiolare</i>					
		Licorice Plant	.6 x 1.5	As Shown	300mm
WM <i>Westringia 'Mundi'</i>					
		Mundi Westringia	0.5 x 1.5	As Shown	300mm
Asm <i>Acmena smithii</i> var. <i>minor</i>					
		Dwarf Lillypillly	3 x 2	As Shown	300mm
CE <i>Callistemon 'Endevour'</i>					
		Bottlebrush	2.5 x 2.5	As Shown	300mm
CBF <i>Callistemon 'Great Balls of Fire'</i>					
		Bottlebrush	1.75 x 1.75	As Shown	300mm
CV <i>Callistemon viminalis</i> 'Little John'					
		Little John Bottlebrush	.8 x .8	As Shown	300mm
GM <i>Grevillea Moonlight</i>					
		Moonlight Grevillea	4 x 3	As Shown	300mm
NGS <i>Nandina 'Gulf Stream'</i>					
		Nandina	.75 x .5	As Shown	300mm
Vo <i>Viburnum odoratissimum</i>					
		Sweet Viburnum	3 x 2	As Shown	300mm
Groundcovers/ Grasses					
Ad <i>Alternanthera dentata</i> 'Little Ruby'					
		Little Ruby	0.4 x 0.9	5/m2	150mm
Cg <i>Carpobrotus glaucescens</i>					
		Pigface	.1 x .3	5/m2	150mm
Gt <i>Gazania tomentosa</i>					
		Silver Gazania	0.3 x 1.5	5/m2	150mm
Dr <i>Dichondra repens</i>					
		Kidney Grass	.1 x 1	5/m2	150mm
GRM <i>Grevillea 'Poorinda Royal Mantle'</i>					
		Royal Mantle Grevillea	.4 x 1	5/m2	150mm
Hv <i>Hardenbergia violacea</i>					
		Native Lilac	.5 x 1	5/m2	150mm
LEG <i>Lirope muscari</i> 'Evergreen Giant'					
		Giant Lirope	0.6 x 0.5	5/m2	150mm
LT <i>Lomandra longifolia</i> 'Tanika'					
		Tanika	.5 x .5	5/m2	150mm
Mp <i>Myoporum parvifolium</i>					
		Creeping Boobialla	.2 x .2	5/m2	150mm
PN <i>Pennisetum 'Nafray'</i>					
		Nafray Pennisetum	.6 x .6	5/m2	150mm
PE <i>Poa 'Eskdale'</i>					
		Eskdale Tussock Grass	0.7 x 0.6	5/m2	150mm
PK <i>Poa 'Kingsdale'</i>					
		Kingsdale Tussock Grass	0.5 x 0.6	5/m2	150mm
TJ <i>Trachelospermum jasminoides</i>					
		Star Jasmine	0.3 x 1.5	5/m2	150mm



Building 1
Magnolia grandiflora 'Exmouth'



Building 2
Lagerstroemia indica x *fauriei* 'Natchez'



Building 3
Pyrus calleryana 'Chanticleer'



Building 4
Gleditsia triacanthos var. *inermis* 'Sunburst'



Building 5
Pistacia chinensis



Building 6
Sapium sebiferum

© 2016 Site Image (NSW) Pty Ltd. ABN 44 801 262 380 as agent for Site Image NSW Partnership. All rights reserved. This drawing is copyright and shall not be reproduced or copied in any form or by any means (graphic, electronic or mechanical including photocopy) without the written permission of Site Image (NSW) Pty Ltd. Any license, expressed or implied, to use this document for any purpose what so ever is restricted to the terms of the written agreement between Site Image (NSW) Pty Ltd and the instructing party.

The contractor shall check and verify all work on site (including work by others) before commencing the landscape installation. Any discrepancies are to be reported to the Project Manager or Landscape Architect prior to commencing work. Do not scale this drawing. Any required dimensions not shown shall be referred to the Landscape Architect for confirmation.

B Architectural Coordination
A Preliminary
Issue Revision Description
JW NM 03.10.2019
JD NM 27.09.2019
Drawn Check Date

Client:

Mirvac

Project:

300 Manchester Road, Auburn

SITE IMAGE
Level 1, 3-5 Baptist Street
Redfern NSW 2016
Australia
Tel: (61 2) 8332 5600
Fax: (61 2) 9698 2877
www.siteimage.com.au
Site Image (NSW) Pty Ltd
ABN 44 801 262 380
Landscape Architects

PRELIMINARY

Drawing Name:

Landscape Details

Scale: As shown

Job Number:

SS19-4190

Drawing Number:

501

Issue:

B

NOT FOR CONSTRUCTION